

PINOUT

DESCRIPTION:

Pinout for Pro Co ConcertMaster 37-pin Cable/Panel-mount female multipin connectors (TLDC37LF06, TL37PF26) Rear pinout view shown.

NOTE: This is also the front view for male connectors.

ABBREVIATIONS:

- S = Shield
- + = Hot (+)
- = Cold (-)

STANDARD PREP LENGTHS:

Channel #	Length
1 - 8	2-5/8"
9 - 16	1-7/8"
17 - 24	3"
25 - 32	1-1/2"

37-PIN TOURLINE MULTIPIN CONNECTOR PART NUMBERS:

PART NUMBER	DESCRIPTION
TLDC37LF06	Female, Cable mount, w/Locking ring, Dust cap
TLDC37PF26	Female, Panel mount, w/Locking ring, Dust cap
TLDC37LM01	Male, Cable mount, Dust cap
TLDC37PM02	Male, Panel mount, Dust cap

All Tourline multipin connectors are delivered pre-populated with solder-type contacts. Replacement contacts and tools are available from Pro Co. Please contact 800-253-7360 for assistance.

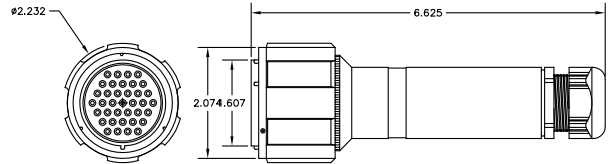

TL-37-LF06: 37 PIN FEMALE CABLE MOUNT CONNECTOR

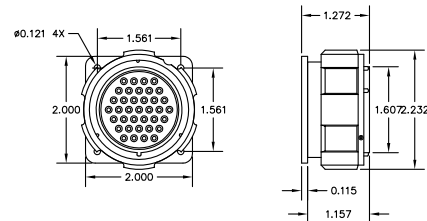

TL-37-PF26: 37 PIN FEMALE PANEL MOUNT CONNECTOR

REAR VIEW

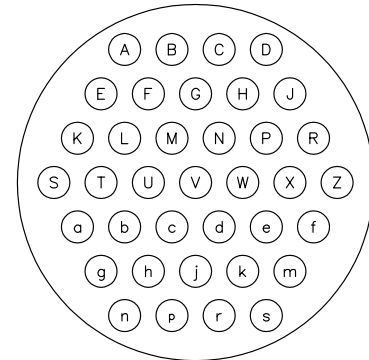

TL-37-PF26: 37 PIN FEMALE CONNECTOR

CHANNEL PINOUT			
CHANNEL	+	-	S
1	E	F	A
2	B	C	G
3	H	J	D
4	S	T	K
5	L	M	U
6	V	W	N
7	P	R	X
8	a	b	g
9	c	d	j
10	e	f	m
11	n	p	h
12	r	s	k