



On Stage with the Best

TradeTools™

DB2

STEREO DIRECT BOX

APPLICATION INFORMATION

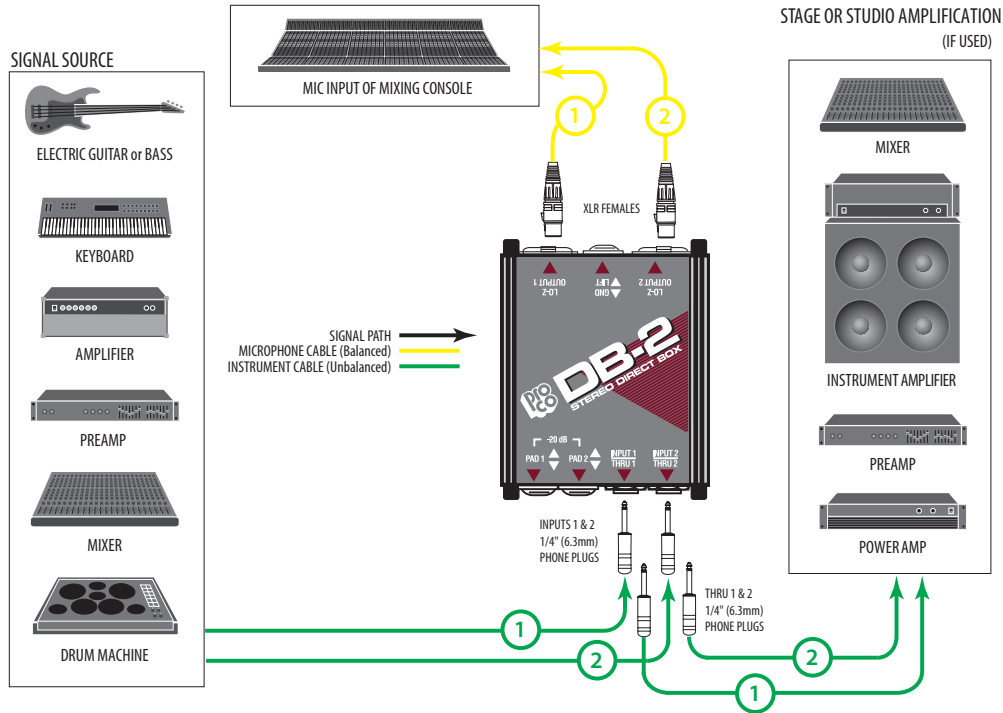

2-CHANNEL (STEREO) APPLICATION

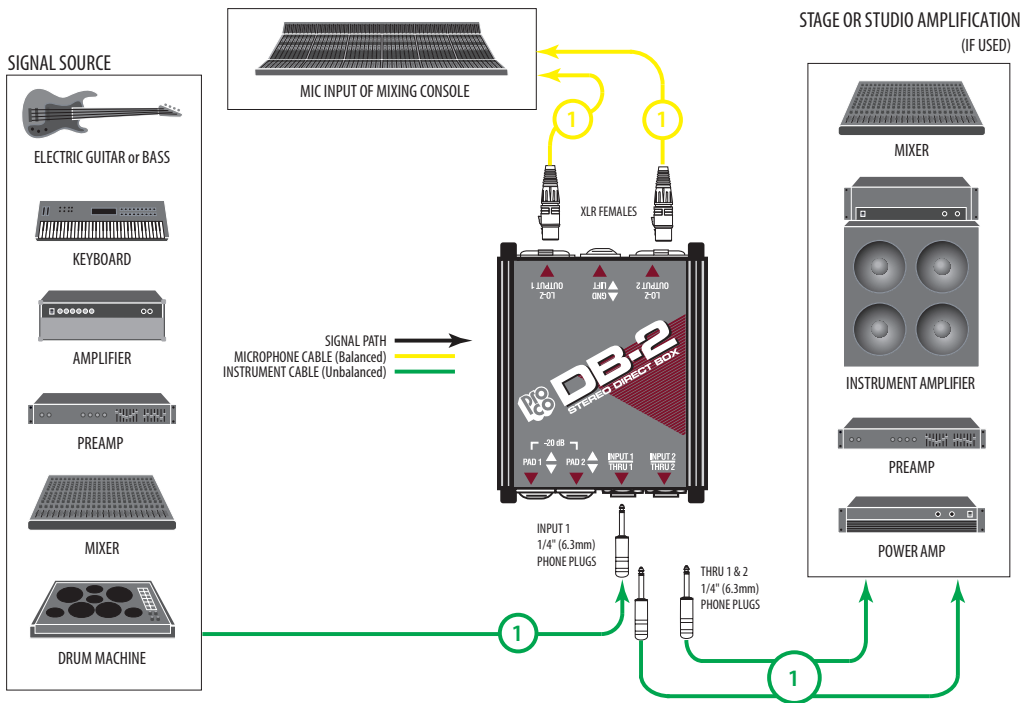

1 INPUT TRANSFORMER-ISOLATED SPLITTER APPLICATION

# CONTROLS:

## INPUT 1/2:

1/4" (6.3mm) phone jack accepts signals from instrument or other source. Input impedance-greater than 100 kohm; SPKR- approx. 8 kohm. Handles signals of up to 69V RMS (approx. 600 watts across an 8 ohm load).

## THRU 1/2:

1/4" (6.3mm) phone jack provides "loop-through" parallel connection from input jack. Used when inserting DB2 between instrument and amplifier.

## 20 dB PAD:

ON (up) position inserts a 20 dB PAD between INPUT and DBT-P transformer for increased level handling capability. Used for line-level sources. OFF (down) position bypasses PAD. 20dB PAD affects LO-Z OUTPUT response only).

## LO-Z OUTPUT:

Male 3-pin XLR-type connector provides balanced floating low-impedance output (pin 2 hot). Connect to mixing board microphone channel input. Recommended load impedance: 1.0 kohm.

## GND/LIFT:

GND position connects INPUT and LO-Z OUTPUT grounds together. LIFT position "floats" LO-Z OUTPUT. Used to reduce hum and buzz by eliminating ground loops and providing proper grounding for various conditions.

# NOTES ON CONTROL SETTINGS:

1. LO-Z OUTPUT is connected to microphone input of house P.A. mixer or recording console.
2. GND/LIFT switch settings assume the mixer is also the central ground reference point for the system. **For safety reasons all equipment should be equipped with 3-wire AC power cords and plugged into properly grounded receptacles.** Use of the GND/LIFT switch should minimize hum and buzz. If GND/LIFT switch seems non-functional, check wiring of cable plugged into the LO-Z OUTPUT. A cable with a jumper between pin 1 and the connector shell will defeat the GND/LIFT switch.

# CIRCUIT DIAGRAM:

